

MAGIC MESH™

Hands-Free Screen Door Installation Instructions

IMPORTANT: Before hanging, ensure that the surface is clean of dirt and debris.

SINGLE DOORS:

Determine the proper direction to install screen:

- If your door opens IN, install on the OUTSIDE of the door frame.
- If your door opens OUT, install on the INSIDE of the door frame.

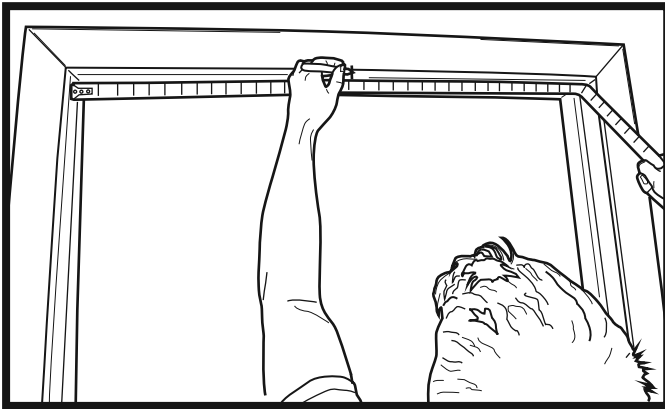

1. Find and mark the center of the top of your door frame.

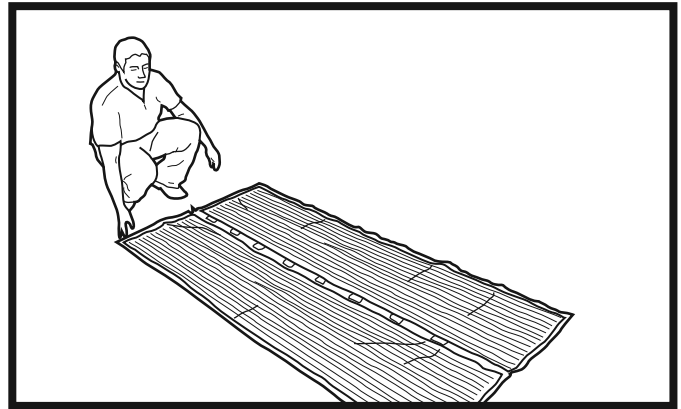

2. Lay your Magic Mesh™ Screen flat on the floor with magnets aligned in the center. **Note:** The top of the panel will have a larger gap between the magnets and the trim versus the bottom of the panel. Check each magnet to ensure they attract to each other symmetrically.

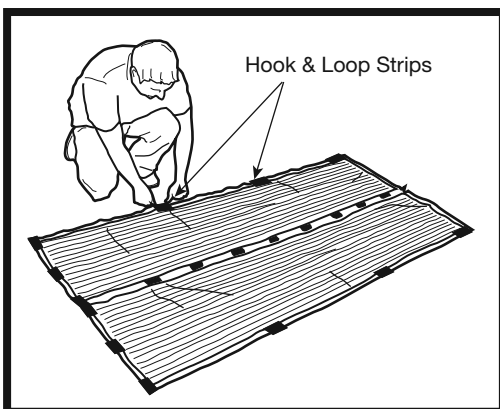

3. Peel the adhesive backing off of the hook and loop strips and apply to the Magic Mesh™ Screen according to FIGURE 1.

FIGURE 1

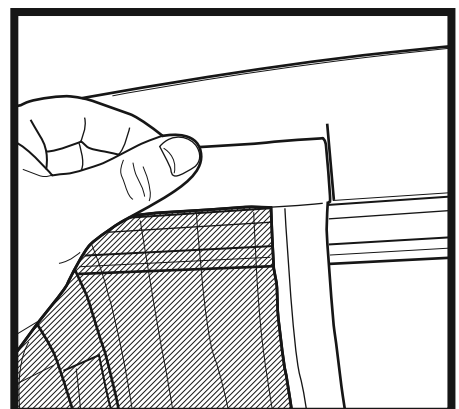
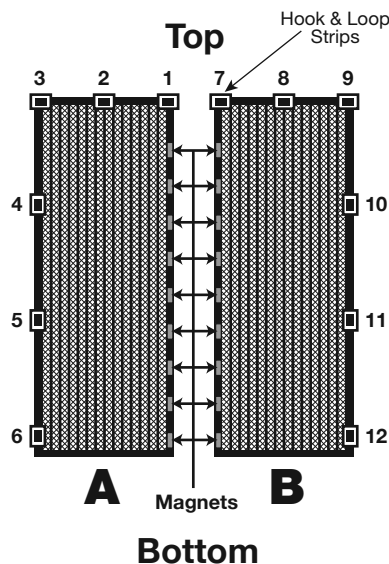

4. Take Panel A and peel off adhesive backing of hook and loop strip #1 and apply to center of door frame with pressure. Hold for 30 seconds. **Note:** Be sure to hang the screen high enough so that it does not drag on the ground.

Continued on Page 2...

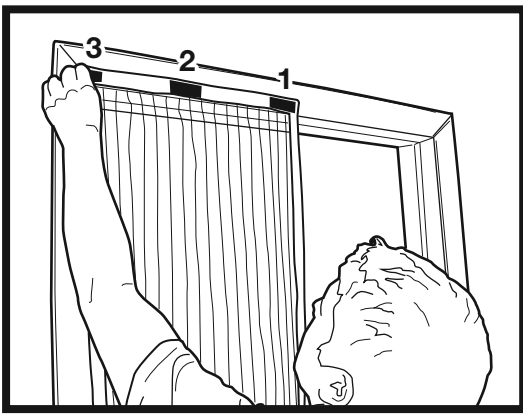

5. Repeat for hook and loop strips #2 and #3.

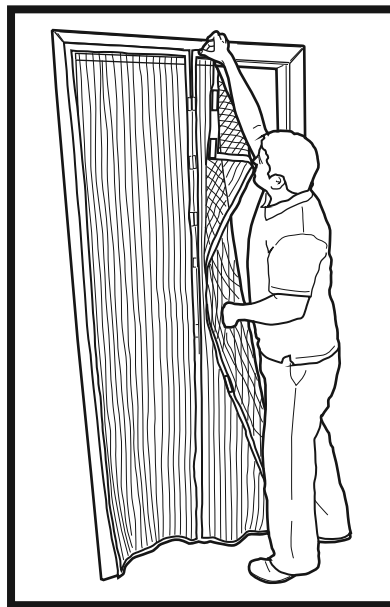
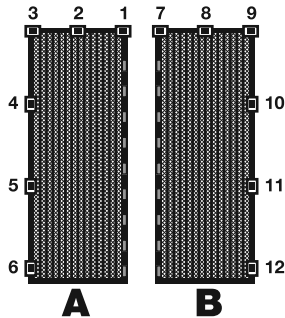

6. Take Panel B and peel off adhesive backing of hook & loop strip #7. Raise Panel B and allow magnets to connect together. Once magnets are connected and aligned in the center, apply hook and loop adhesive to door frame. Hold for 30 seconds. **Note:** Be sure to hang the screen high enough so that it does not drag on the ground. Ensure the magnets are properly connected and aligned in the center.

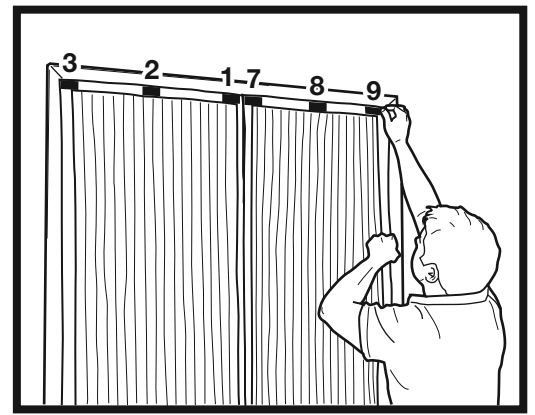

7. Repeat for hook and loop strips #8 and #9.

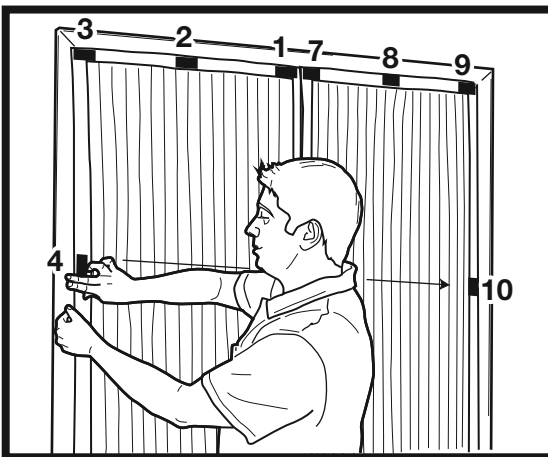

8. Attach the rest of the hook and loop strips row by row: #4 & #10, #5 & #11 and #6 & #12.

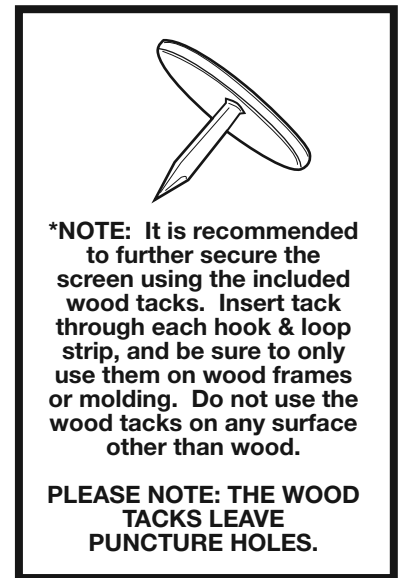
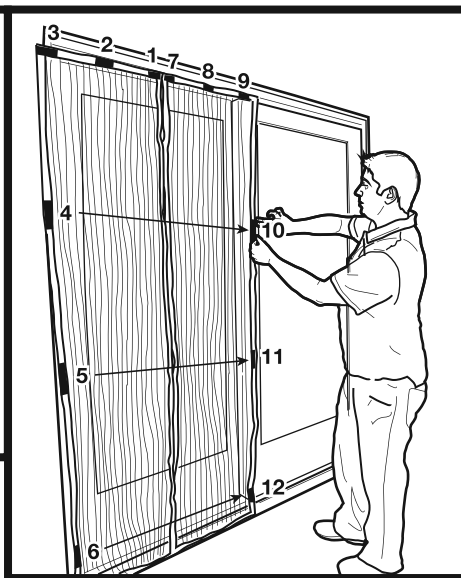

***NOTE:** It is recommended to further secure the screen using the included wood tacks. Insert tack through each hook & loop strip, and be sure to only use them on wood frames or molding. Do not use the wood tacks on any surface other than wood.

PLEASE NOTE: THE WOOD TACKS LEAVE PUNCTURE HOLES.

Helpful Tips & Troubleshooting:

If magnets do not snap shut together, adjust the width positioning of the mesh. Your mesh panels may be attached too far over and need to be brought closer to the middle so the magnets attract to each other.

Cleaning and Storage:

- Do not use any harsh or abrasive cleaners on this product.
- Wipe off the mesh with a damp, lukewarm cloth. For stubborn dirt, you can spot clean with a small amount of soap and a cloth. Allow the mesh to air-dry.
- Do not put in dryer. Do not dry clean.

Safety Information:

- Keep children away from the packaging material. There is danger of suffocation.
- Maintain adequate distance from heat sources such as stovetops or ovens.
- Because of possible electromagnetic interference, people with implanted medical devices (e.g. pace makers) should consult their doctor before using.
- Take extra caution when using wood tacks. Keep away from children.
- Product may not function properly if not installed correctly.

FOR MORE INFO & HELPFUL TIPS, VISIT:
www.magicmeshinfo.com
 or www.facebook.com/magicmesh

IMPORTANT: Before hanging, ensure that the surface is clean of dirt and debris.

SLIDING DOORS:

Important: For sliding doors, attach the screen to the OUTSIDE of the door frame and to the STATIONARY DOOR.
– Removing the sliding screen door may be required if your doorway opening is less than 91.4 cms (36 inches).

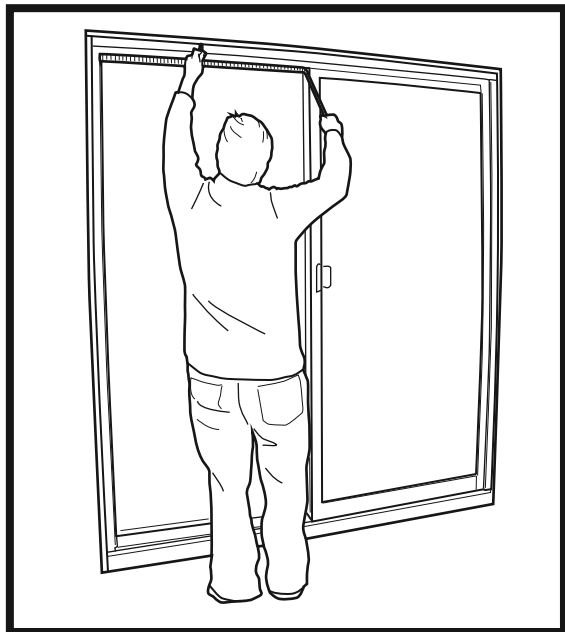

1. Find and mark the center point of the top of the opening door. Measure the opening of the doorway. **Note:** If the opening is less than 91.4 cms (36 inches) we suggest removing the sliding screen door.

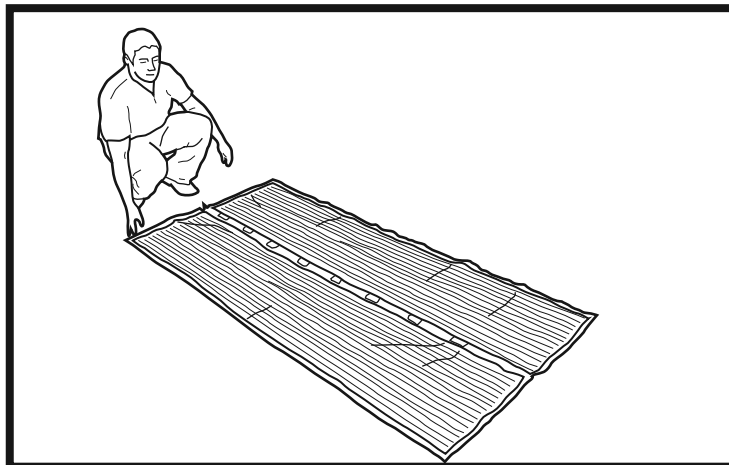

2. Lay your Magic Mesh™ Screen flat on the floor with magnets aligned in the center. **Note:** The top of the panel will have a larger gap between the magnets and the trim versus the bottom of the panel. Check each magnet to ensure they attract to each other symmetrically.

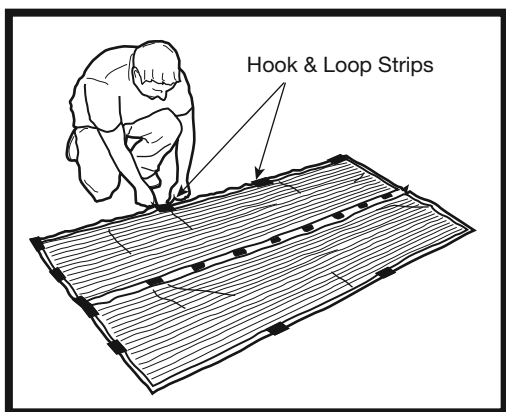

3. Peel the adhesive backing off of the hook and loop strips and apply to the Magic Mesh™ Screen according to FIGURE 1.

FIGURE 1

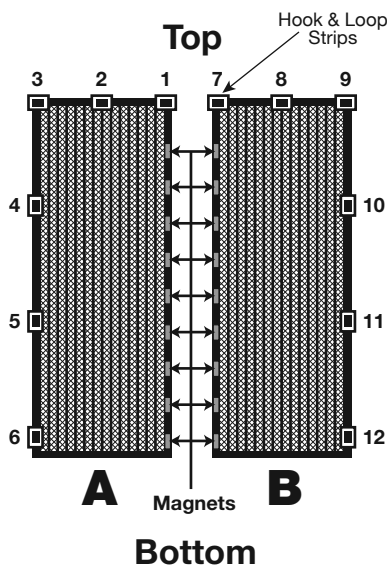

4. Take Panel A and peel off adhesive backing of hook and loop strip #1 and apply to center of door frame with pressure. Hold for 30 seconds. **Note:** Be sure to hang the screen high enough so that it does not drag on the ground.

Continued on Page 4...

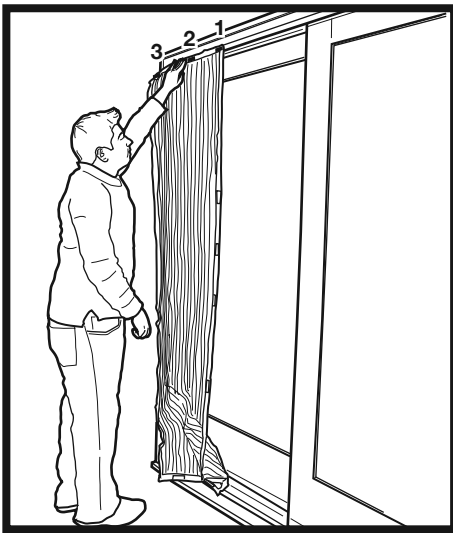

5. Repeat for hook and loop strips #2 and #3.

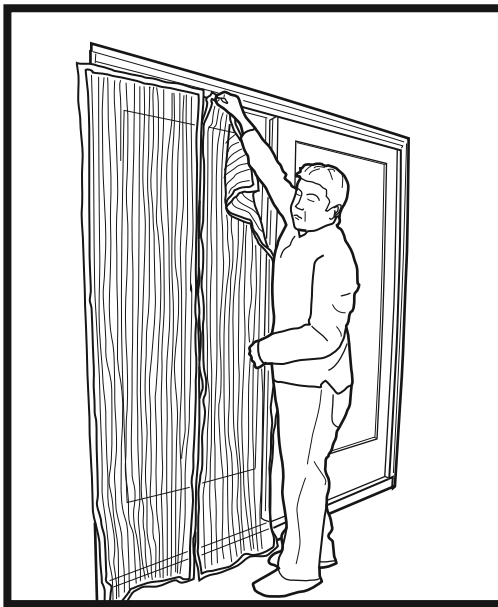

6. Take Panel B and peel off adhesive backing of hook & loop strip #7. Raise Panel B and allow magnets to connect together. Once magnets are connected and aligned in the center, apply hook and loop adhesive to door frame. Hold for 30 seconds. **Note:** Be sure to hang the screen high enough so that it does not drag on the ground. Ensure the magnets are properly connected and aligned in the center.

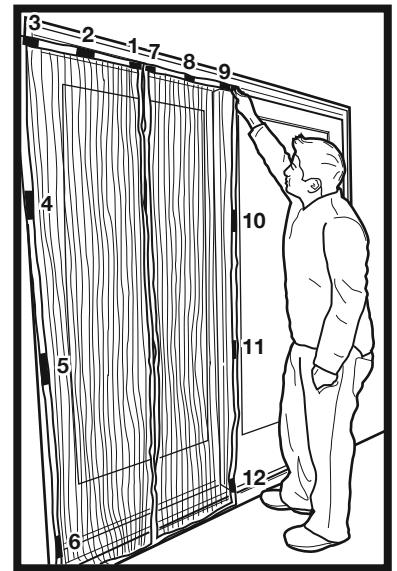

7. Repeat for hook and loop strips #8 and #9. **Note:** Do not apply hook and loop strips to the screen on the sliding screen door. Always attach and secure to the solid door frame surface.

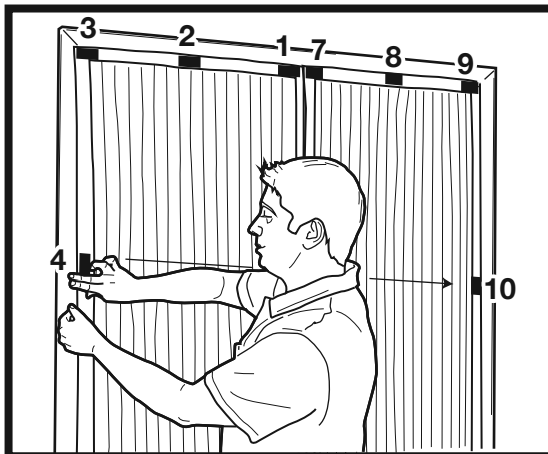
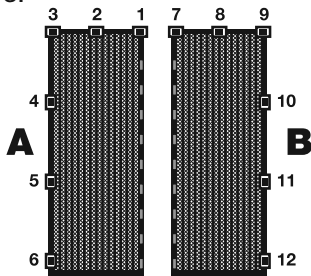

8. Attach the rest of the hook and loop strips row by row: #4 & #10, #5 & #11 and #6 & #12.

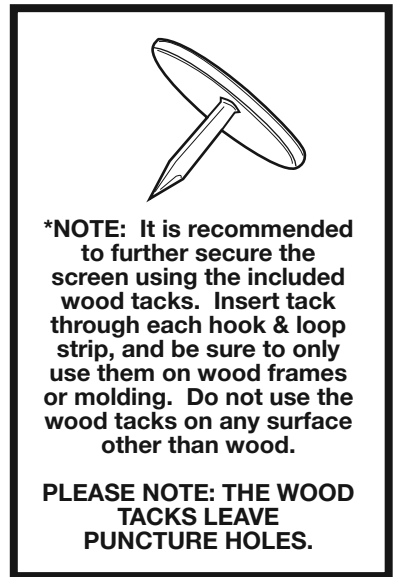
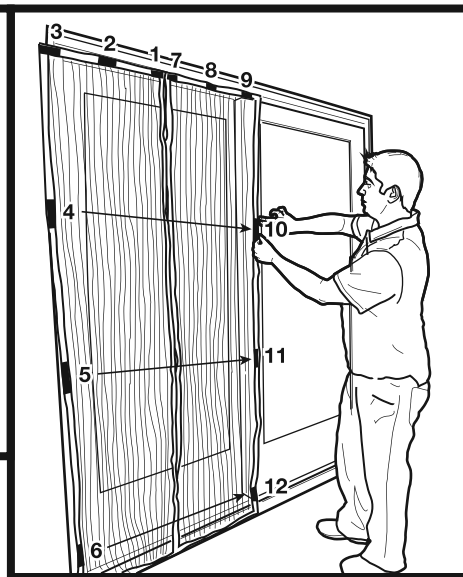

Helpful Tips & Troubleshooting:

- If magnets do not snap shut together, adjust the width positioning of the mesh.
- Your mesh panels may be attached too far over and need to be brought closer to the middle so the magnets attract to each other.
- Do not attempt to attach the wood tacks to glass, vinyl or aluminum siding or to the door/door frame. They should only be used for wooden frames or walls.
- Do not apply hook and loop strips to the screen on the sliding screen door. Always attach and secure to the solid door frame surface.

Cleaning and Storage:

- Do not use any harsh or abrasive cleaners on this product.
- Wipe off the mesh with a damp, lukewarm cloth. For stubborn dirt, you can spot clean with a small amount of soap and a cloth. Allow the mesh to air-dry.
- Do not put in dryer. Do not dry clean.

Safety Information:

- Keep children away from the packaging material. There is danger of suffocation.
- Maintain adequate distance from heat sources such as stovetops or ovens.
- Because of possible electromagnetic interference, people with implanted medical devices (e.g. pace makers) should consult their doctor before using.
- Take extra caution when using wood tacks. Keep away from children.
- Product may not function properly if not installed correctly.

FOR MORE INFO & HELPFUL TIPS, VISIT:
www.magicmeshinfo.com
 or www.facebook.com/magicmesh



Distributed by: Supertek Canada Inc.
 8605 Damley Rd, Mont-Royal, Qc H4T 1X2
 client@supertek.ca
 Customer Service: 1-800-304-8354